

Resin SteelBinding



 **Unibind®**

BCC10

www.unibind.com



BCC10

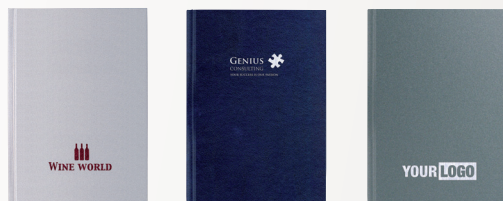

SteelBook
for Resin SteelBinding

Performance

- Automatic binding systems with a capacity for pre-assembled 400 books/hour
- Crimping reduces the amount of spine sizes needed in stock and improves the overall aesthetics of the books

Easy to use

- User-friendly: the only thing the operator has to do, is placing the books into the input tray (up to 10) and remove the bound books
- The machine does all the work; it Binds, Crimps and Cools fully automatically

Quality

- For professional, industrial and intensive usage
- Firmly bound books

Reliability

- Pre-programmed panel to adjust binding temperature
- Adjustable for various spine sizes and cover formats
- To provide maximum operator safety the BCC10 is engineered as a closed environment with both loading and unloading trays closed while the machine is operational

System Specifications

- 2960 x 880 x 1400 mm
- 530 kg
- 1500 Watt
- 120 or 240 V
- Frequency 50~60 Hz
- Air pressure 6 Bar
- 12,5 A (at 120 V) or 6,3 A (at 240 V)
- 87 Psi
- Air consumption \pm 550 Liter/hour (at max. throughput)
- Throughput 400 HardCover Books/hour

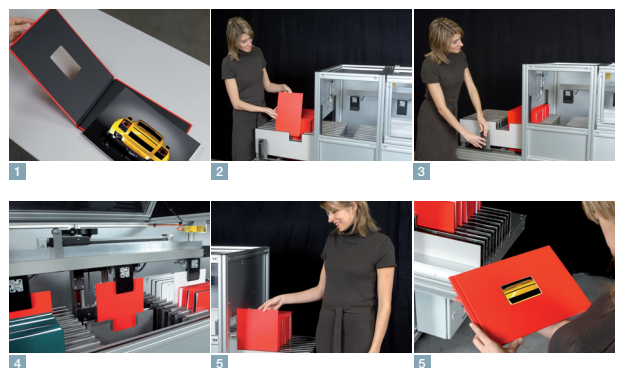

www.unibind.com



Resin SteelBinding